

P3) Tabla striata neagra 2000x5mm

Sc. 1:10

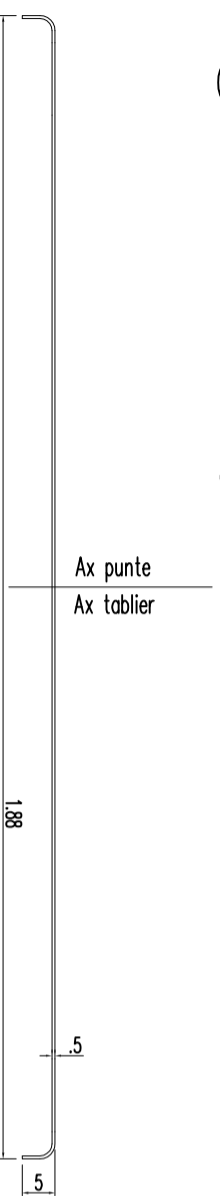

P6) Rigidizare
pe reazeme

Sc. 1:10

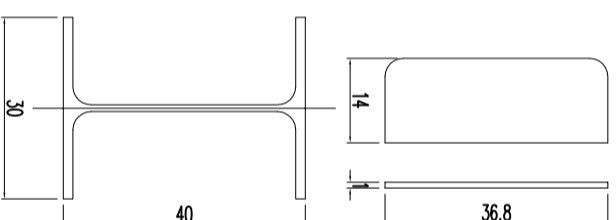

P4) Profil 50x30x5mm

Sc. 1:10

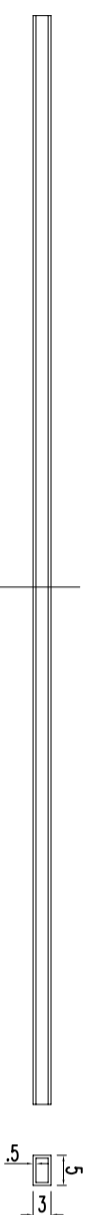

P5) Antretoaza HEA 400

Sc. 1:10

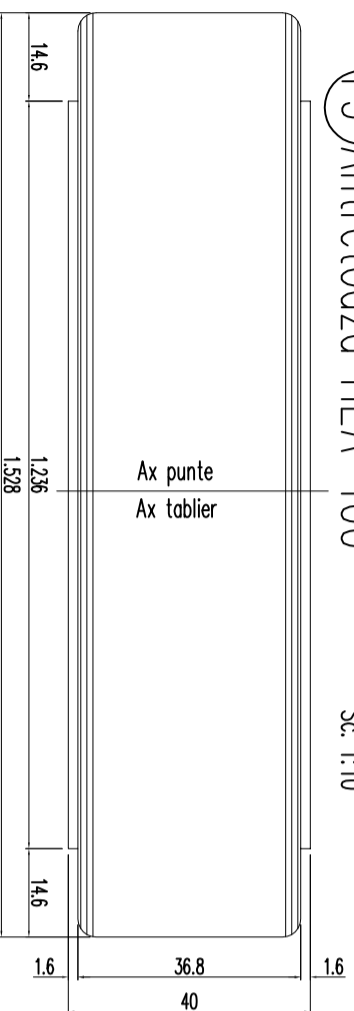

P7) Detalii sudura la talpa
grinda HEA 400

Sc. 1:10

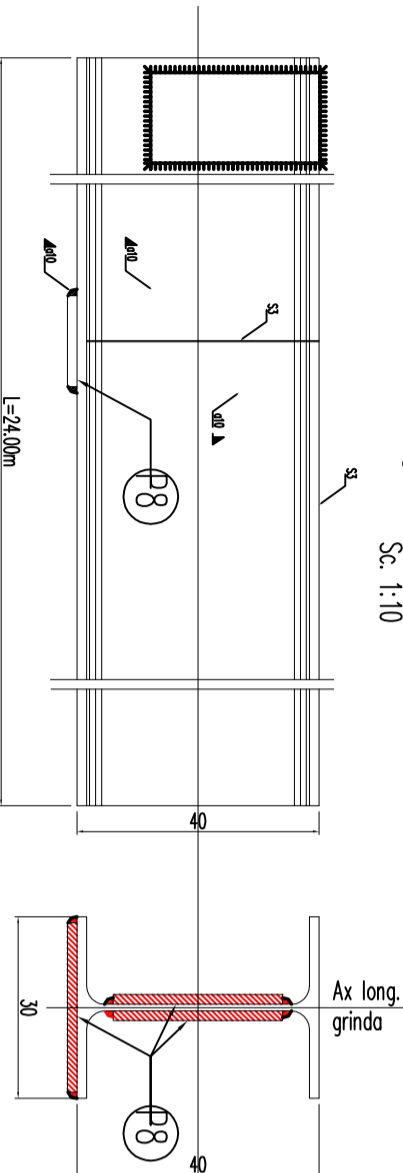

P8) Detalii placuta imbinare
talpa grinzi

Sc. 1:10

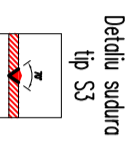
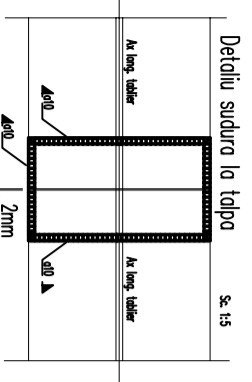
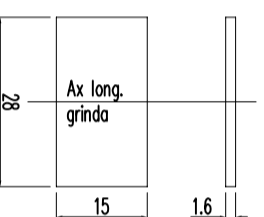

Nr. Piesa	Denumire	Tip	Lungime mm	Masa kg/buc.	Nr. buc.	Masa Totala kg	Marca Otel
		mm					
P1	Mana curenta	150x100x8	27435	759.95	2	1325	S 235
P2	Zabrele	120x100x8	1640	39.20	36	1228	S 235
P3	Tabla striata	2000x5	24100	1638.80	1	1427	S 235
P4	Traverse	50x30x5	1800	7.69	76	510	S 235
P5	Antretoaza	HEA 400	1528	191.00	7	1167	S 355
P6	Rigidizare pe reazeme	140x10	368	4.05	16	57	OL 52
P7	Grinzi	HEA 400	24000	3000.00	2	5225	S 355
P8	Placuta imbinare	280x16	150	5.28	6	28	OL 52
				Total kg		10967	
				Sudura 5% kg		548.35	
				Total kg structura		11515.35	

Acest document este proprietatea firmei s.c. AQUA PROCIV PROIECT s.r.l. si nu poate fi folosit, transmis sau reprodus, total sau partial, fara autorizarea expresa si scrisa; utilizarea sa trebuie sa fie conforma celei pentru care a fost elaborat. Documentul este valabil numai cu semnaturile si stampila in original.

s.c. AQUA PROCIV PROIECT s.r.l. PROIECTARE SI STUDII str. Septimiu Albini nr.118, Cluj-Napoca		Scara 1:10	Beneficiar: Administrația Bazinului de Apa Banat Investiție: "Aparare împotriva inundațiilor a municipiului Caransebes, zona Aeroport, zona Caransebesul Nou, jud. Caras-Severn"	Proiect nr. 942/2020 Faza P.T.+D.E.
Proiectat	ing. Dan SACUI	Data 2021		Planșa nr. 4.2.16
Desenat	ing. Marius STERIU			
Verificat	ing. Dragos GROS			
Sef proiect	ing. Dan SACUI			